



## • 订购规格 Order specifications:

 201 锁紧螺母 材料: 尼龙塑料  
 201 Locknut Material: nylon plastic

	M	SW	D	H	订购号 Order No.
	M16 × 1.5	22	Φ24	5	<b>201/16</b>
	M20 × 1.5	26	Φ29	6	<b>201/20</b>
	M25 × 1.5	32	Φ35	6	<b>201/25</b>
	M32 × 1.5	40	Φ44	7	<b>201/32</b>
	M40 × 1.5	50	Φ55	7	<b>201/40</b>
	M50 × 1.5	60	Φ66	7	<b>201/50</b>
	M63 × 1.5	75	Φ83	9	<b>201/63</b>

 202 锁紧螺母 材料: 钢制表面镀锌  
 202 Locknut Material: steel with galvanized surface

	M	SW	H	订购号 Order No.
	M16 × 1.5	19	3.5	<b>202/16</b>
	M20 × 1.5	24	3.5	<b>202/20</b>
	M25 × 1.5	30	3.5	<b>202/25</b>
	M32 × 1.5	36	4	<b>202/32</b>
	M40 × 1.5	46	4	<b>202/40</b>
	M50 × 1.5	55	5	<b>202/50</b>
	M63 × 1.5	70	6	<b>202/63</b>
	M75 × 2	85	8	<b>202/75</b>
	M80 × 2	90	9	<b>202/80</b>
	M90 × 2	100	10	<b>202/90</b>
	M100 × 2	110	12	<b>202/100</b>

 203 锁紧螺母 材料: 铜制  
 203 Locknut Material: brass

	M	SW	H	订购号 Order No.
	M16 × 1.5	19	3.5	<b>203/16</b>
	M20 × 1.5	24	3.5	<b>203/20</b>
	M25 × 1.5	30	3.5	<b>203/25</b>
	M32 × 1.5	36	4	<b>203/32</b>
	M40 × 1.5	46	4	<b>203/40</b>
	M50 × 1.5	55	5	<b>203/50</b>
	M63 × 1.5	70	6	<b>203/63</b>
	M75 × 2	85	8	<b>203/75</b>
	M80 × 2	90	9	<b>203/80</b>
	M90 × 2	100	10	<b>203/90</b>
	M100 × 2	110	12	<b>203/100</b>

## • 外形尺寸 Outline dimensions:

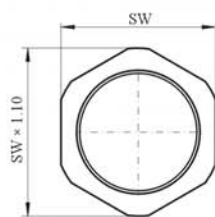

202、203

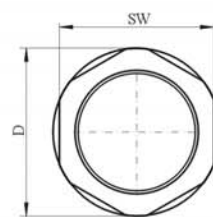

201

● 主要数据 Main technical data:

认证 Certification | 防爆标志 Ex mark | 符合标准 Meet the standard

China (PCEC Ex)	Ex e II	DIP A21 TA	GB3836	GB12476
IECEX			IEC60079	
ATEX			EN60079	

适用范围: 用于 1 区和 2 区  
                  用于 21 区和 2 区

Intended use: Can be used in zone 1 and zone 2  
                                  Can be used in zone 21 and zone 22

防护等级: IP65

Degree of protection: IP65

材 料: 铝制表面喷涂

Material: Aluminum surface spraying

● 订购规格 Order specifications:



编码 Code	入口螺纹 Entry thread	电缆直径 Cable diameter	G	L	L1	L2	SW1	SW2	订购号 Order No.
D01	M20 × 1.5	Φ 8-11	G1/2"	61	15	22	30	26	<b>CZ0222 2015 e201</b>
D02	M25 × 1.5	Φ 11-15	G3/4"	61	15	22	35	30	<b>CZ0222 2515 e202</b>
D03	M32 × 1.5	Φ 11-19	G1"	65	15	24.5	41	37	<b>CZ0222 3215 e203</b>
D04	M40 × 1.5	Φ 18-27	G1 1/4"	78	16	34.5	53	48.5	<b>CZ0222 4016 e204</b>
D05	M50 × 1.5	Φ 26-34	G1 1/2"	80	16	34.5	60	55	<b>CZ0222 5016 e205</b>

螺钉固定 Fixed by screws



编码 Code	螺钉固定 Secured by screws ΦC	电缆直径 Cable diameter	G	L	L1	L2	SW	ΦB	订购号 Order No.
D07	75	Φ 40-46	G2"	70	70	34	64	47	<b>CZ0222 0070 e207</b>
D08	90	Φ 53-61	G2 1/2"	82	86	44	79	62	<b>CZ0222 0086 e208</b>
D09	106	Φ 57-68	G3"	82	100	44	92	69	<b>CZ0222 0100 e209</b>
D10	75	Φ 35-42	G2"	70	70	34	64	47	<b>CZ0222 0070 e210</b>
D11	90	Φ 46-54	G2 1/2"	82	86	44	79	62	<b>CZ0222 0070 e211</b>

● 外形尺寸 Outline dimensions:

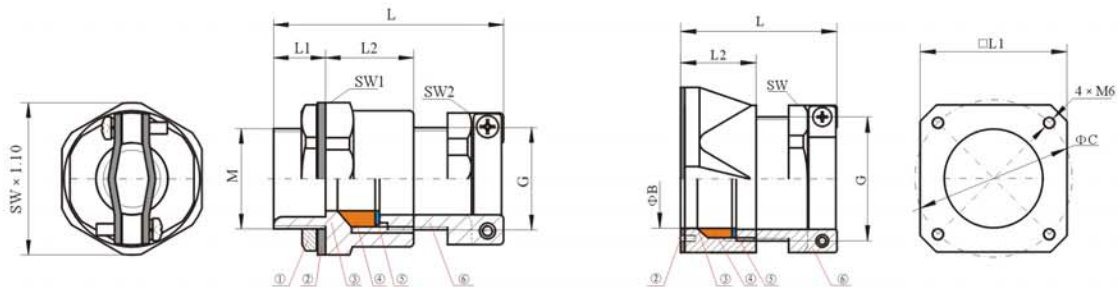

- ① 锁紧螺母            Locknut
- ② 200 密封垫        Sealing washer
- ③ 0222 接体         Entry body
- ④ 0227 密封圈       Sealing ring
- ⑤ 205 垫圈          Washer
- ⑥ 208 防拔脱螺母   Nut with a clamping device